

Built Environment

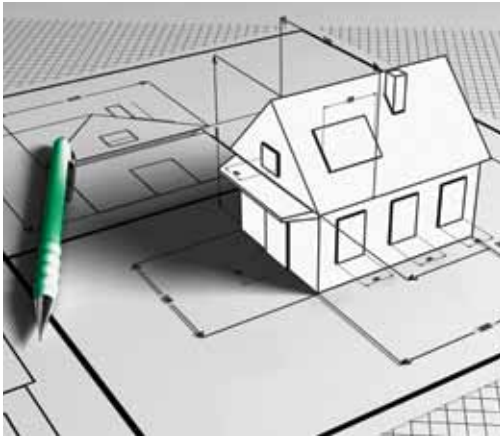

The largest collection specializing in this field, with an article downloaded every minute from among 17 journal titles.

Journal

ISSN: 2044-124X Volume: 2 Print Issues: 2 Internet Issues: 2 www.emeraldinsight.com/bepam.htm

RECENT LAUNCH
2011



Built Environment Project and Asset Management

Editors

Professor Mohan Kumaraswamy
The University of Hong Kong, Hong Kong

Dr Linda Fan
The Hong Kong Polytechnic University, Hong Kong

Built Environment Project and Asset Management (BEPAM) provides a niche forum to address interfaces between project management and asset management of building and civil engineering infrastructure.

Project planning with project impact assessments; infrastructure demand analysis (with emphasis on sustainability); stakeholder management (including appropriate engagement); procurement management (with longer-term criteria, e.g. in public private partnerships etc.); design management; construction management; Infrastructure condition ratings; sustainable

construction and life cycle optimisation; critical infrastructure protection and disaster mitigation management; and preventive maintenance, asset rehabilitation and replacement management.

Benefits and features

- BEPAM provides a unique one-stop forum that links leading-edge research to cutting-edge practice in the general domain of physical infrastructure development.
- BEPAM supplies the missing link between built environment project management and built environment asset management.

Journal

ISSN: 1471-4175 Volume: 12 Print Issues: 4 Internet Issues: 4 www.emeraldinsight.com/ci.htm



Construction Innovation

Information, Process, Management

Advances in technological research, combined with highly advanced IT systems, have prompted a period of rapid growth in the construction industry. With its focus on innovation and its unique combination of technology, process and people, Construction Innovation (CI) is unfolding a coherent picture of a future construction vision.

Coverage includes:

Advanced automation systems in construction; information management; standardization and data exchange; mobile technology; IT-based innovations and business competitiveness; business process engineering

and process improvement; management strategies and market positioning; organizational e-readiness and soft issues; smart and sustainable environments; visualization and integration; and modelling and simulation.

Benefits and features

- CI is formally encouraged by the CIB (International Council for Research and Innovation in Building and Construction).



Journal ISSN: 0969-9988 Volume: 19 Print Issues: 6 Internet Issues: 6 www.emeraldinsight.com/ecam.htm



Engineering, Construction and Architectural Management

Editors

Editor: Professor Ronald McCaffer
Loughborough University, UK
Deputy Editor: Professor Antony Thorpe
Loughborough University, UK

Engineering, Construction and Architectural Management (ECAM) focuses on developments in the management and practice of construction. Through empirical research, modelling, surveys and investigations, the journal addresses a wide spectrum of construction issues from national and international perspectives.

Coverage includes:

Building; civil engineering; major infrastructure; repair and maintenance; design and construction processes;

the management of construction companies and architectural practices; and industry developments from a national and international perspective.

Benefits and features

- ECAM is formally encouraged by the CIB (International Council for Research and Innovation in Building and Construction).



Journal ISSN: 0263-2772 Volume: 30 Print Issues: 14 Internet Issues: 14 www.emeraldinsight.com/f.htm



Facilities

Editor

Professor Edward Finch
University of Salford, UK

Facilities (F) covers the multidisciplinary topics of people, property and process management expertise which underpin successful organizational functions in the workplace.

It offers serious discussion of key issues to help managers, architects and other interested parties to maximize building space resources.

Coverage includes:

Intelligent buildings; post-occupancy evaluation; relocation and change management; ergonomics and workplace design; environmental and workplace

psychology; design and construction; infrastructure management; and environment and climate change.

Benefits and features

- *Facilities* is the first journal in the field of facilities management with an "academic" refereed content.
- *Facilities* is formally encouraged by the CIB (International Council for Research and Innovation in Building and Construction).



Journal ISSN: 1759-5908 Volume: 3 Print Issues: 3 Internet Issues: 3 www.emeraldinsight.com/ijdrbe.htm



International Journal of Disaster Resilience in the Built Environment

Editors

Professor Dilanthi Amaratunga and Dr Richard Haigh
University of Salford, UK

International Journal of Disaster Resilience in the Built Environment (IJDRBE) is the only journal to promote research and scholarly activity that examine the role of building and construction to anticipate and respond to unexpected events that damage or destroy the built environment.

Coverage includes:

Disaster prevention, mitigation, response and reconstruction; construction project management for post-disaster reconstruction; and assessment of disaster-related damage.

Benefits and features

- The leading journal contributing to the body of knowledge on disaster mitigation, response and reconstruction within the context of the built environment.
- *IJDRBE* is formally encouraged by the CIB (International Council for Research and Innovation in Building and Construction) for its relevance and link with the industry and academia.



Journal

ISSN: 1753-8270 Volume: 5 Print Issues: 4 Internet Issues: 4 www.emeraldinsight.com/ijhma.htm



Editor

Professor Richard Reed
Deakin University, Australia

International Journal of

Housing Markets and Analysis

The *International Journal of Housing Markets and Analysis (IJHMA)* aims to provide an international forum for the interchange of information and ideas relating to housing, housing markets and the interaction thereof.

Coverage includes:

Housing market analysis; social housing considerations and influences; demographics and the relationship with housing; the effect of financial factors on housing markets; first-time buyers or first home owners; the effect

of government decisions on housing; taxation of housing; emerging housing markets; conversion and modification of houses; and the environment and housing.

Benefits and features

- *IJHMA* provides international and cross-cultural coverage, publishing papers that capture or provide insight into the differences in housing market considerations and practice across regions and countries.

Journal

ISSN: 1756-1450 Volume: 4 Print Issues: 3 Internet Issues: 3 www.emeraldinsight.com/ijlbe.htm



Editor

Paul Chynoweth
University of Salford, UK

International Journal of

Law in the Built Environment

The *International Journal of Law in the Built Environment (IJLBE)* provides a vehicle for the publication of high quality legal scholarship in the context of the design, construction, management and use of the built environment.

Coverage includes:

The law relating to construction contracts and procurement; the law of real property, the land-related torts and neighbour disputes; landlord and tenant law, including dilapidations, rent review and housing law; planning, building control, conservation and environmental law; conflict management, ADR, litigation and the expert witness; negligence, professional liability and indemnity; comparative legal studies in the built

environment; private international law in the context of the built environment; jurisprudential and theoretical perspectives on law in the built environment; the role of legal research and scholarship in the built environment; and law teaching and curriculum development in built environment professional education.

Benefits and features

- *IJLBE* is formally encouraged by the CIB (International Council for Research and Innovation in Building and Construction).



Journal

ISSN: 1463-001X Volume: 14 Print Issues: 4 Internet Issues: 4 www.emeraldinsight.com/jcre.htm



Editor

Dr Clare Eriksson
Head of Research, RICS, UK

Journal of

Corporate Real Estate

***Journal of Corporate Real Estate (JCRES)* is the world's leading peer reviewed, professional journal dedicated to corporate real estate.**

Coverage includes:

Financial strategies; flexibility; portfolio management; construction delivery; workplace productivity; negotiation and dispute resolution; leasing; the cost of capital; strategic planning; cost control; management structures; outsourcing; corporate tenancy; IT; relocation; demand forecasting; rationalization; and insurance and lease issues post-9/11.

Benefits and features

- *JCRE* provides access to practical experiences of blue-chip companies and government bodies worldwide, with case studies detailing the problems they have met and the lessons they have learned.
- *JCRE* looks at how some of the world's largest corporate occupiers are confronting the critical issues they face in managing large-scale real estate portfolios.

Journal

ISSN: 2044-1266 Volume: 2 Print Issues: 2 Internet Issues: 2 www.emeraldinsight.com/jchmsd.htm*Journal of*

Cultural Heritage Management and Sustainable Development

The *Journal of Cultural Heritage Management and Sustainable Development (JCHMSD)* stimulates and encourages research devoted to the sustainable development of cultural heritage and to the positive contribution of cultural heritage management towards a sustainable environment.

Coverage includes:

Cultural heritage – assessment, management, marketing and publicity; sustainable development – preservation, conservation, restoration, rehabilitation, reconstruction, demolition, best practices, unsustainable development

and consequent threats; and cultural heritage and sustainable development – legislation, effects of climate change, ecological sustainability, social sustainability, economic sustainability.

Benefits and features

- *JCHMSD* is the only journal linking cultural heritage management with sustainable development.
- *JCHMSD* is international: the challenging tasks of managing cultural heritage while aiming for sustainable development and managing sustainability while redeveloping cultural heritage are on all countries' agenda.

Editors

Dr Ana Pereira Roders
Eindhoven University of
Technology, The Netherlands

Dr Ron van Oers
UNESCO World Heritage
Centre, France

Journal

ISSN: 1726-0531 Volume: 10 Print Issues: 3 Internet Issues: 3 www.emeraldinsight.com/jedt.htm*Journal of*

Engineering, Design and Technology

***Journal of Engineering, Design and Technology (JEDT)* serves all practitioners, professionals and clients in the engineering, design and technology sectors.**

Coverage includes:

Design strategies; usability and adaptability; material, component and systems performance; process control; alternative and new technologies; organizational, management and research issues; human factors; environmental, quality and health and safety issues; cost and life cycle issues; sustainability criteria, indicators, measurement and practices; risk management; entrepreneurship; law, regulation and governance;

designing, implementing, managing and practising innovation; visualization, simulation, information and communication technologies; and education practices, innovation, strategies and policy issues.

Benefits and features

- *JEDT* is endorsed by the Chartered Institute of Building, Africa and is formally encouraged by the CIB (International Council for Research and Innovation in Building and Construction).

Editor

Professor Theo Haupt
Mississippi State University,
USA



“The *Journal of Engineering, Design and Technology* is arguably one of the finest up and coming peer-reviewed international research journals available to construction and engineering academics and practitioners. The depth and breadth of content are superb and reflect well on a discipline that has reached maturity in recent years. Editorial is another attractive attribute of *JEDT* – in terms of both the actual “physical” quality of published scientific papers, on the one hand, and the absolute professionalism with which the peer review process is handled, on the other hand. This exemplary team effort ensures that authors are dealt with in a fair and timely manner. It is a great pleasure and honour to be associated with this journal.”

Dr David John Edwards, Loughborough University, UK

Journal

ISSN: 1753-9269 Volume: 5 Print Issues: 3 Internet Issues: 3 www.emeraldinsight.com/jerer.htm



Editor

Professor Stanley McGreal
University of Ulster, UK

Journal of

European Real Estate Research

The *Journal of European Real Estate Research (JERER)* aims to provide a European forum for the interchange of information and ideas relating to commercial and residential property. The journal seeks to publish well-written, readable articles of intellectual rigour with a theoretical and practical relevance to the real estate profession in Europe.

Coverage includes:

European real estate; REITs and financial derivatives; housing and residential markets; indirect property investment; cross-border portfolio diversification; comparative market analysis; banking; analytical techniques and applications in practice; and sustainability and investment value.

Benefits and features

- High-quality research articles with clear indications of practice to ensure relevance and applicability.
- A unique journal that considers commercial and residential property together.
- Papers that concentrate on the expansion of the European real estate market.



Journal of European Real Estate is the official journal of the European Real Estate Society.

Journal

ISSN: 1472-5967 Volume: 10 Print Issues: 4 Internet Issues: 4 www.emeraldinsight.com/jfm.htm



Editor

Professor Michael R. Pitt
University College London, UK

Journal of

Facilities Management

Journal of Facilities Management (JFM) publishes high-quality, authoritative and detailed analysis, briefings and case studies on how facilities can and do play a vital part in helping deliver corporate strategy.

Coverage includes:

Strategic planning; performance measurement; disaster recovery and business continuity planning; life cycle management; contracting and procurement; project management; workplace design and strategy; and space planning.

Benefits and features

- *JFM* features a combination of theoretical and practical articles, complemented by case studies identifying key implications for senior practitioners in facilities management.
- *JFM* provides the latest thinking on how to link capital and strategic planning.
- *JFM* features contributions from some of the leading companies, government institutions and universities in the facilities management area.

Journal

ISSN: 1366-4387 Volume: 17 Print Issues: 3 Internet Issues: 3 www.emeraldinsight.com/jfmipc.htm



Editors

Professor Akintola Akintoye
University of Central Lancashire, UK

Dr Jim Birnie
UK

Journal of

Financial Management of Property and Construction

The *Journal of Financial Management of Property and Construction (JFMPC)* brings together theoretical- and practical-based developments and new thinking in the financial management of property and construction.

Coverage includes:

Project and corporate financing; risk management; market analysis, modeling and valuation of property; capital structure decisions and management; building/construction economics; investment theory and practice; sustainability and renewal; financial implications of IT systems; financial aspect of statutory regulations, energy

and environment; and cost evaluation and financial implications of alternative procurement methods.

Benefits and features

- *JFMPC* is formally encouraged by the CIB (International Council for Research and Innovation in Building and Construction) and is an approved RICS Foundation journal.

RICS FOUNDATION



Journal

ISSN: 1753-8335 Volume: 5 Print Issues: 3 Internet Issues: 3 www.emeraldinsight.com/jpmd.htm

Journal of

Place Management and Development

Place management is a coordinated, area-based, multi-stakeholder approach, harnessing the skills, experience and resources of those in the public, private and voluntary sectors. The *Journal of Place Management and Development (JPMD)* aims to provide a central repository for research into this expanding topic, pulling together theory and practice in the field.

Coverage includes:

Organizational and governance structures in place management; the marketing and branding of places; the consumption of place; design and planning considerations; regeneration; place competitiveness; community

engagement and development; sustainable communities; local economic development; tourism; town centre management; and neighbourhood and community renewal.

Benefits and features

- High-quality research articles with clear indications for practice to ensure relevance and applicability.
- The journal publishes practically-focused case studies.
- *JPMD* is the official journal of the Institute of Place Management.

**Editors**

Professor Cathy Parker
Manchester Metropolitan
University, UK

Dr John Byrom
University of Tasmania,
Australia

Simon Quin
Institute of Place Management,
UK

Journal

ISSN: 1463-578X Volume: 30 Print Issues: 6 Internet Issues: 6 www.emeraldinsight.com/jpif.htm

Journal of

Property Investment & Finance

Widely regarded as one of the best property journals in its field, the *Journal of Property Investment & Finance (JPIF)* provides an international forum for the interchange of information and ideas relating to property valuation and investment.

Coverage includes:

Real estate portfolios and practice; micro- and macro-economics issues; valuation methods; forecasting; and rental and capital determinants.

Benefits and features

- *JPIF* is widely acknowledged to be the "leading journal for publishing international real estate".
- *JPIF* gives a comprehensive review of new legislation and the latest approaches to give an all-round view of the latest developments in the property field.
- *JPIF* operates a rigorous double blind reviewing system (three reviewers), ensuring that high quality is maintained and developed.

Editor

Professor Nick French
Oxford Brookes University, UK

“The *Journal of Property Investment & Finance* has for many years been essential reading for all those keen to understand the trends and changes impacting property as an investment asset. It is rare for a journal to so successfully combine theoretical perspectives with an emphasis on relevance and practical application.”

Paul McNamara, PRUPIM, UK

Journal

ISSN: 0263-7472 Volume: 30 Print Issues: 5 Internet Issues: 5 www.emeraldinsight.com/pm.htm



Property Management

By addressing key issues from an international perspective *Property Management (PM)* publishes articles which aim to keep academics and practitioners in the field conversant with new thinking and research. It provides an invaluable resource for everyone with a professional and academic interest in all aspects of property management.

Editor

Clive Warren
Associate Professor, University of Queensland, Australia

Coverage includes:

Valuation – theory and practice; sustainability; occupiers' issues; asset management; taxation; development and

redevelopment; landlord and tenant; maintenance and refurbishment; environmental issues; and security.

Benefits and features

- The broad scope of *PM* ensures comprehensive coverage of the property life cycle from development through occupation to redevelopment.
- *PM* publishes topical research dedicated to academics and practitioners in the field, ensuring widespread readership.

Journal

ISSN: 2046-6099 Volume: 1 Print Issues: 3 Internet Issues: 3 www.emeraldinsight.com/sasbe.htm



Smart and Sustainable Built Environment

NEW LAUNCH
2012

Smart and Sustainable Built Environment (SASBE) aims to inform research and industry practice on integrated approaches to developing smart and sustainable built environments, linking together the various sustainable targets, bottom-lines, endpoints and project deliverables through whole development cycles and project processes.

Editor

Professor Jay Yang
Queensland University of Technology, Australia

Coverage includes:

Smart and sustainable buildings, infrastructure, districts, cities and the community; design, development and operation of smart and healthy workplace and living

environments; and new systems, innovative technologies and high performance products responding to emerging challenges such as climate change, closed materials loops, security, alternative energy, passive design, lifecycle assessment, and integration with natural systems.

Benefits and features

- *SASBE* is the only journal that focuses on integrated approaches to developing innovative systems, methods, and practices for sustainable products and outcomes of the built environments.

Journal

ISSN: 0263-080X Volume: 30 Print Issues: 5 Internet Issues: 5 www.emeraldinsight.com/ss.htm

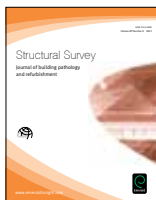

Structural Survey

Journal of building pathology and refurbishment

Structural Survey (SS) is the leading information resource, offering access to expert comments and advice on all aspects of the inspection and appraisal of buildings.

Editors

Professor Mike Hoxley and Dr Mark Shelbourn
Nottingham Trent University, UK

Coverage includes:

Building conservation, regulations and codes; case studies of refurbishment products; engineering services survey; materials, components and building defects; practice abroad; surveying commercial and residential buildings; and law and practice of dilapidation.

Benefits and features

- *SS* includes a review of the latest certificates issued by the British Board of Agrément as well as incorporating a selected listing of books, articles, pamphlets and reports received by the Building Research Establishment Library.
- *SS* is formally encouraged by the CIB (International Council for Research and Innovation in Building and Construction).

